

STEP 7

SAFETY DEVICE (CHAIN ONLY)

The safety device must be installed at the maximum distance possible from the control mechanism to prevent looped chain becoming slack.

Place the safety device on the wall and mark the positioning of the 2 screw holes.

Drill holes using a suitable drill bit.

Place device into position ensuring the chain is fully taut. Screw into position ensuring device is fully closed.

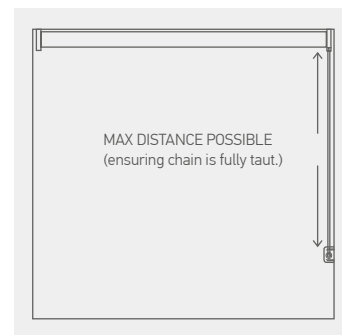

STEP 8

RETAINING DEVICE (CHAIN ONLY)

Attach retaining device using suitable fixings ensuring the device is fully closed.

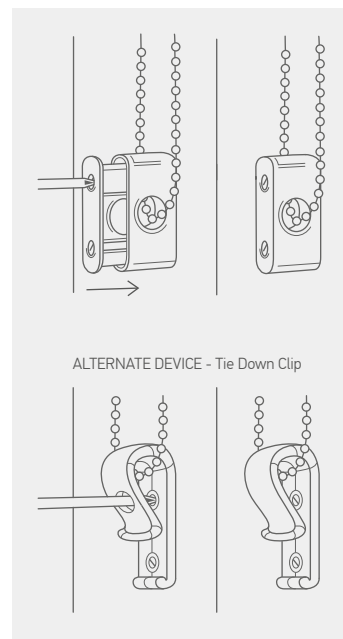

RETAINING DEVICE (CRANK ONLY)

Attach crank handle retaining device using suitable fixings ensuring the device is fully closed.

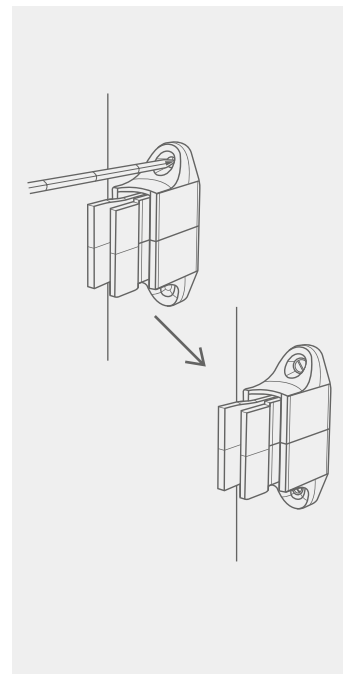

PLEASE READ THE INSTRUCTIONS BEFORE OPERATING THIS PRODUCT

OPERATION INSTRUCTIONS

BEAD CHAIN OPERATION

1. To lower the fabric on the cassette gently pull the operating chain closest to the window until the bottom bar is fully inserted into the bottom channel. Do not pull the chain further as this may damage the fabric.

2. To raise the fabric on the cassette gently pull the operating chain furthest from the window until the fabric is at the desired position. Once the top of the bottom bar is touching the headbox do not pull the operating chain any further as this will potentially damage the blind and cause operational issues.

3. Where possible operating chain should be operated from just above the easy break chain connector as this puts less pressure on this component, reducing the risk of snapping or pulling apart.

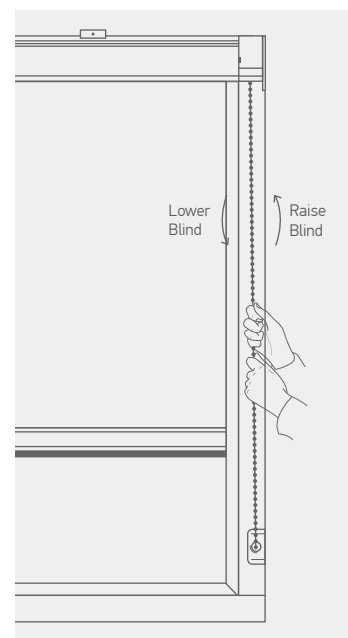

FITTING INSTRUCTIONS: SYSTEM 55 CASSETTE

PLEASE READ THE INSTRUCTIONS BEFORE OPERATING THIS PRODUCT

OPERATION INSTRUCTIONS

CRANK OPERATION

1. To lower the fabric on the cassette rotate the operating handle clockwise until the bottom bar is fully inserted into the bottom channel.

2. To raise the fabric on the cassette rotate the operating handle anti-clockwise until the fabric is at the desired position. Once the top of the bottom bar is touching the headbox do not rotate further as this will potentially damage the blind and cause operational issues.

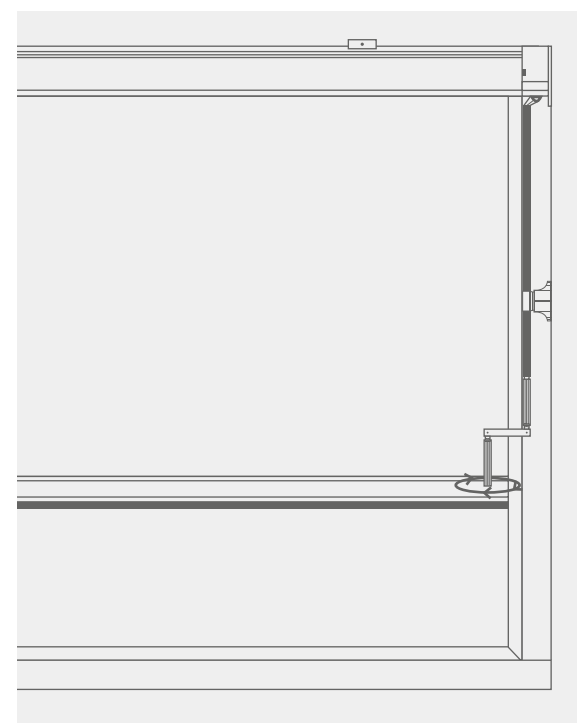

MAINTENANCE

The product is maintenance free however we recommend that regular visual checks are completed to ensure that no components have been damaged, which could result in operating difficulties and/or cause a safety risk.

If any maintenance is required we recommend that the work is carried out immediately, by a reputable blind company.



WARNING

Young children can be strangled by loops in pull cords, chains, tapes and inner cords that operate the product.

To avoid strangulation and entanglement, keep cords out of the reach of young children. Cords may become wrapped around a child's neck. Move beds, cots and furniture away from window covering cords.

Do not tie cords together. Make sure cords do not twist and create a loop.

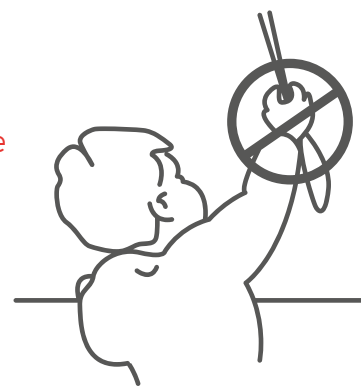

System 55 Cassette

FITTING INSTRUCTIONS (1.2)

YOU SHOULD HAVE

SYSTEM 55 ITEM LIST



TOOLS REQUIRED

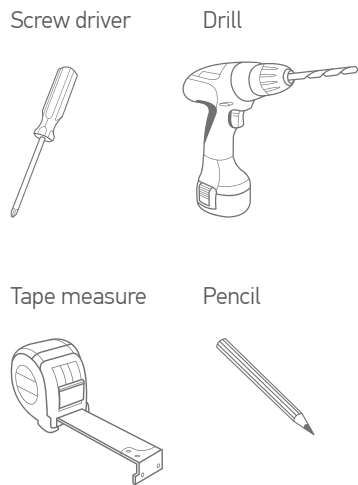

STEP 1

The installation of this product should be conducted by someone competent in DIY.

OUTSIDE RECESS

If the blind is to be fitted outside the window ensure that measurement C is the same. Follow instructions for FACE FIXING. To calculate C (A-B)/2.

INSIDE RECESS

TOP FIX to the lintel. FACE FIX bracket to the window frame.

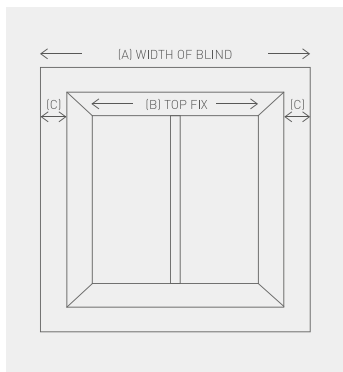

Children can strangle if a safety device is not installed. Always use a safety device to keep cords and chains out of reach of children.

STEP 2

FACE FIXING

1. Assemble the brackets and mount them in the desired location on the wall using screws suited to the target material. One bracket should be placed about 20mm from either end of the blind. Extra brackets should be evenly spaced between these.

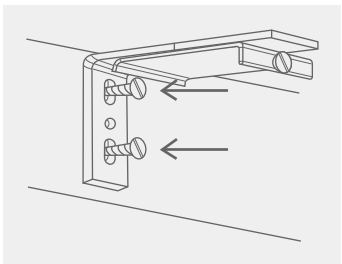

2. Attach the cassette to the bracket making sure it has caught the back lip of bracket as shown, and rotate into a horizontal position whilst keeping it tight against the bracket.

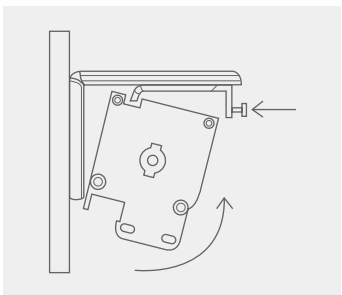

3. Once in the horizontal position tighten the bolt in each bracket, ensuring that the headrail is secure.

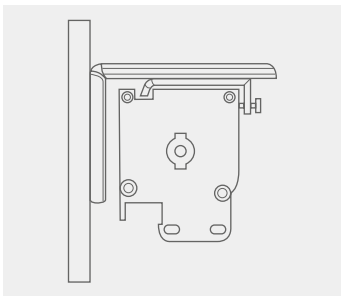

STEP 3

TOP FIXING

1. Mount brackets in desired location on wall using screws suited to the target material. One bracket should be placed about 20mm from either end of the blind. If required, extra brackets should be evenly spaced between these.

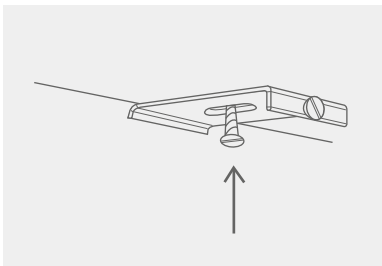

2. Attach the cassette to the bracket making sure it has caught the back lip of bracket as shown, and rotate into a horizontal position whilst keeping it tight against the bracket.

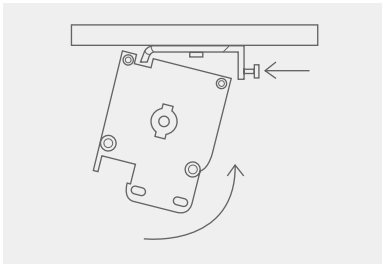

3. Once in the horizontal position tighten the bolt in each bracket, ensuring that the headrail is secure.

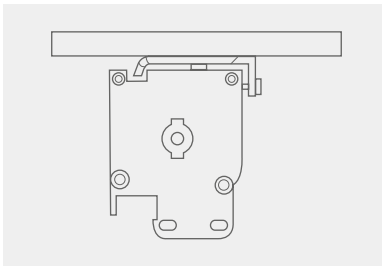

STEP 4

SIDE FIXING

1. Position blind flush to the top of the recess. The endcaps should fit neatly against the sides of the recess.

2. When the blind is in the desired position, mark the positions of the mounting holes on the wall.

3. Remove the blind and prepare the recess for mounting the blind.

4. Screw the blind into position with appropriate fixings.

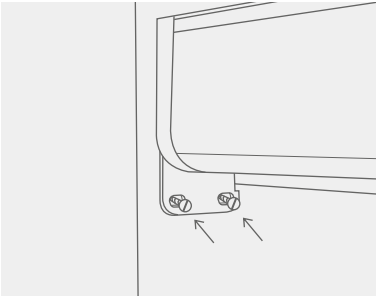

STEP 5

FACEFIX SIDE-GUIDES

1. Place the fixed sideguide profile tight against the cassette end-cap and flush with the edge of the end cap, as shown.

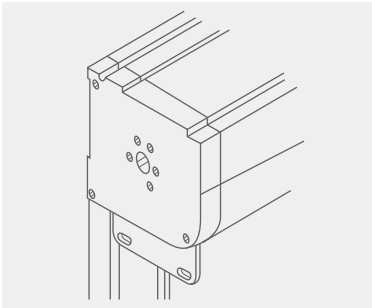

2. Once in position, screw into place at pre-drilled holes using fixings suitable for the target material.

Plastic cover caps are provided to cover the hole once the screw has been inserted.

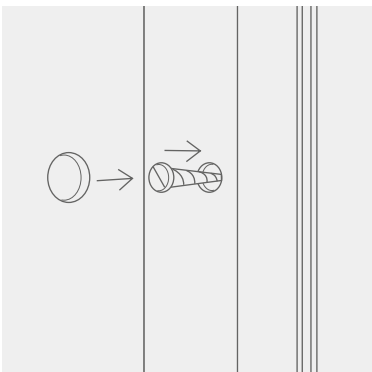

3. Insert adjustable sideguide into fixed sideguide, ensuring that the plastic bottom-bar endcap is slotted into the opening of the adjustable sideguide.

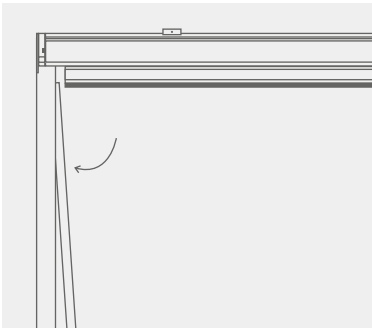

Press the adjustable sideguide into the fixed part, ensuring that the bottom bar will be free to move through it along the full drop of the blind.

The top of the adjustable sideguide should be flush with the top of the fixed part.

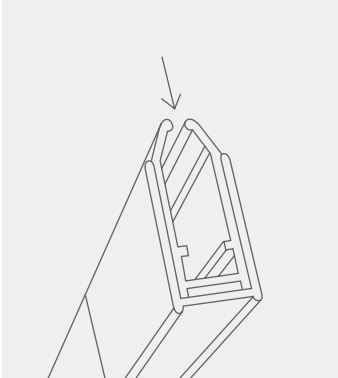

4. Slot bottom channel over the narrow part of the fixed sideguides as shown.

When suitably positioned, drill a hole at the point shown and pop-rivet or screw in place.

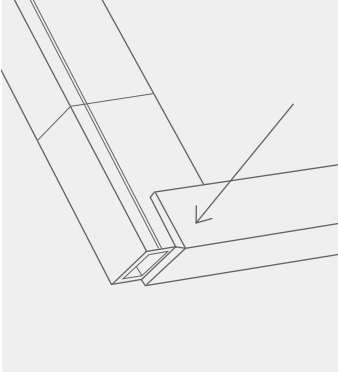

STEP 6

SIDEFIX SIDE-GUIDES

1. a) Set bottom channel into bottom of recess, directly below bottom-rail.

b) Holding the side-guide U-channel at an angle, insert it into opening in cassette/end-cap.

c) Swing the bottom of the sideguide in the direction shown until it is flush with the wall; it should be inside the bottom channel.

d) Screw the sideguides into the wall at the pre-drilled holes using fixings suitable for the target material.

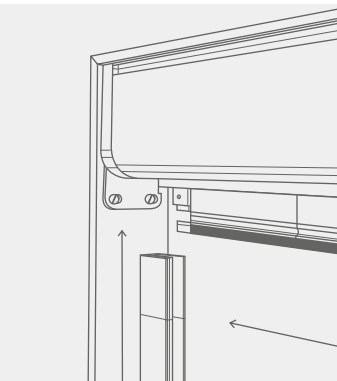

Repeat for the second sideguide.

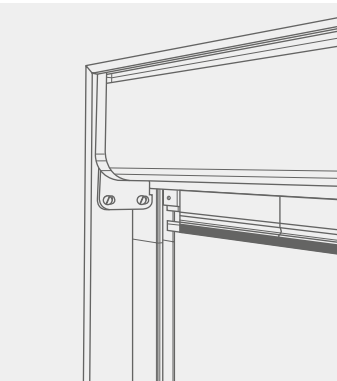

2. a) Press the top of the adjustable sideguide into the fixed part at an angle, as shown.

b) Keeping it angled, push the adjustable part up until it is tight against the bottom of the cassette, ensuring that the plastic bottom-bar endcap is slotted into the opening of the adjustable sideguide.

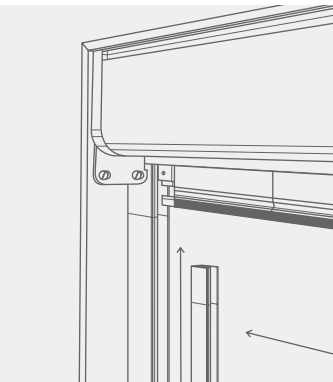

3. Press the adjustable sideguide into the fixed part, ensuring that the bottom bar will be free to move through it along the full drop of the blind.

The top of the adjustable sideguide should be flush with the top of the fixed part.

