



intu<sup>®</sup>

M I C R O  
T E C H N I C A L  
I N F O R M A T I O N P A C K  
**MSP5038 | JANUARY 2019**

### **INTU Micro System**

INTU Micro is a slim line pleated blind system that has been re-developed to allow it to be installed into a wider variety of compact spaces and bi-folding doors. This versatile design is suitable for a variety of bead types and depths. Easy to install and remove - identical to standard INTU with both screw and bead fit fitting methods available.

A tensioned blind system that is entirely child safe by design. There are a variety of blind types to suit your requirements with both standard and multi-zone operation available. Additionally on bead fit blinds we have developed a new Guided Blind Option. Guided endcaps restrain the bottom bar and prevent unwanted movement – this is a beneficial feature when installing on bi-folding doors.

INTU Micro comes in 3 colours - white, anthracite and brown to match both PVC, aluminium and wooden frames. Colour matching components result in a premium finish.

## INTU Micro Bead Fit

### Recommended Size Parameters:

Tensioned Bead Fit/Guided Bead Fit			
Max Width	1000mm	Min Width	250mm
Max Drop	2000mm	Min Drop	250mm
Max Area	2m <sup>2</sup>		

### Control Options:

**Raise/Lower:** Raising and lowering the blind is achieved using the bottom bar. Simply decide on a height, move the bottom bar up or down and it will stay wherever you position it.

**Guided Bead Fit:** Guided endcaps restrain the bottom bar and prevent unwanted movement – this is a beneficial feature when installing on bi-folding doors.

### Measurement Information:

Standard Bead Fit			
Blind Width	Measured Glass Size	Blind Drop	Measured Glass Size
Head Rail	Blind Width - 50mm	Bottom Rail	Blind Width - 20mm
Bottom Rail PVC Insert	Blind Width - 20mm	Side Extrusion	Blind Drop - 9mm
Fabric Size	Blind Width - 7mm	No. of pleats	TS028
Minimum Bead Depth	N/A	No. of cells	TS065
Maximum Bead Depth	N/A		

Guided Bead Fit			
Blind Width	Measured Glass Size	Blind Drop	Measured Glass Size
Head Rail	Blind Width - 50mm	Bottom Rail	Blind Width - 30mm
Bottom Rail PVC Insert	Blind Width - 30mm	Side Extrusion	Blind Drop - 9mm
Fabric Size	Blind Width - 7mm	No. of pleats	TS028
Minimum Bead Depth	N/A	No. of cells	TS065
Maximum Bead Depth	N/A		

**Cord Spacing:**

Cord Spacing		
Blind Width < 590mm	End spacing of 70mm	2 cords
Blind Width > 591mm	End spacing of 70mm	4 cords

**Lift Cord:**

Lift cord colours co-ordinate with fabric colour.

**Installation:**

Installation of blinds is identical to standard INTU Venetian and Pleated. Brackets are installed behind the rubber bead on your door or window. The INTU Micro endcaps are then attached offering a secure fit without the need for screws. For detailed instructions please see Eclipse fitting instructions.

**Blind Tensioning:**

Bead Fit blinds are supplied pre-tensioned. If you need to adjust tension please follow install instructions.

## INTU Micro Screw Fit

### Recommended Size Parameters:

Tensioned Screw Fit			
Max Width	1400mm	Min Width	250mm
Max Drop	2000mm	Min Drop	250mm
Max Area	2.5m <sup>2</sup>		

### Control Options:

Raise/Lower: Raising and lowering the blind is achieved using the bottom bar. Simply decide on a height, move the bottom bar up or down and it will stay wherever you position it.

### Measurement Information:

Screw Fit			
Blind Width	Measured Glass Size	Blind Drop	Measured Glass Size
Head Rail	Blind Width - 50mm	Bottom Rail	Blind Width - 20mm
Bottom Rail PVC Insert	Blind Width - 20mm	Fabric Size	Blind Width - 2mm
Minimum Bead Depth	16mm	No. of pleats	TS028
Maximum Bead Depth	N/A	No. of cells	TS065

### Cord Spacing:

Cord Spacing		
Blind Width < 590mm	End spacing of 70mm	2 cords
Blind Width > 591mm	End spacing of 70mm	4 cords

### Lift Cord:

Lift cord colours co-ordinate with fabric colour.

#### Installation:

Installation of blinds is achieved using 2 fixing screws that are fitted directly to headrail endcaps. Tension cords are fitted using specially designed bead grommets that are installed through drilled holes in the bottom bead of the door/window. Brass bushes are supplied for installations where blind is being fitted to a timber frame. For detailed instructions please see Eclipse fitting instructions.

Installation		
	ALUMINIUM/PVC	TIMBER
Blind Width < 590mm	2.5mm drill bit	4mm drill bit
Blind Width > 590mm	3mm drill bit	5.5mm drill bit

#### Blind Tensioning:

Screw Fit blinds are not supplied pre-tensioned. Tensioning should be carried out by a fitter as per Eclipse Fitting Instructions.

## Exploded Diagram: Bead Fit

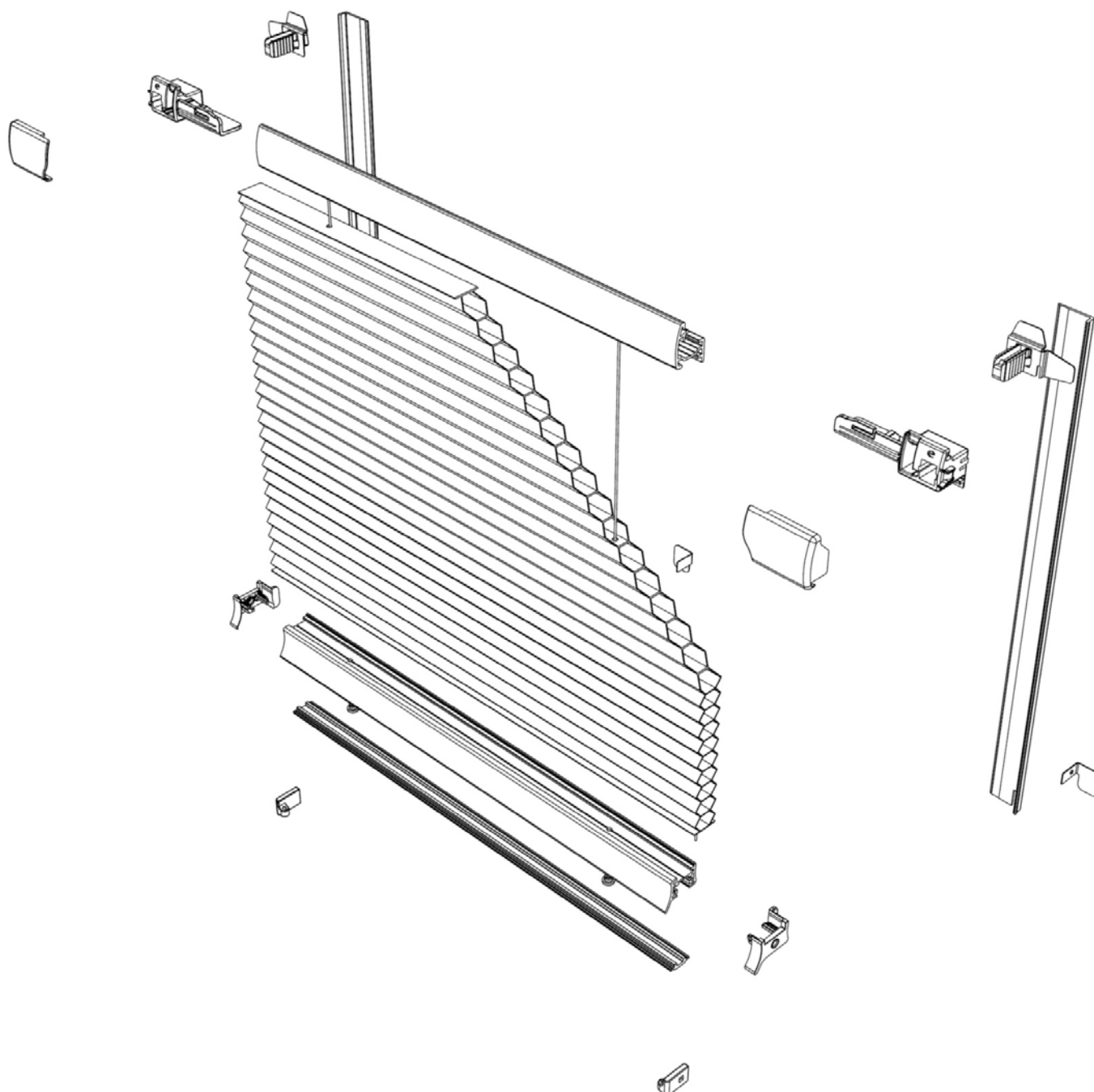



**Exploded Diagram: Guided Bead Fit**

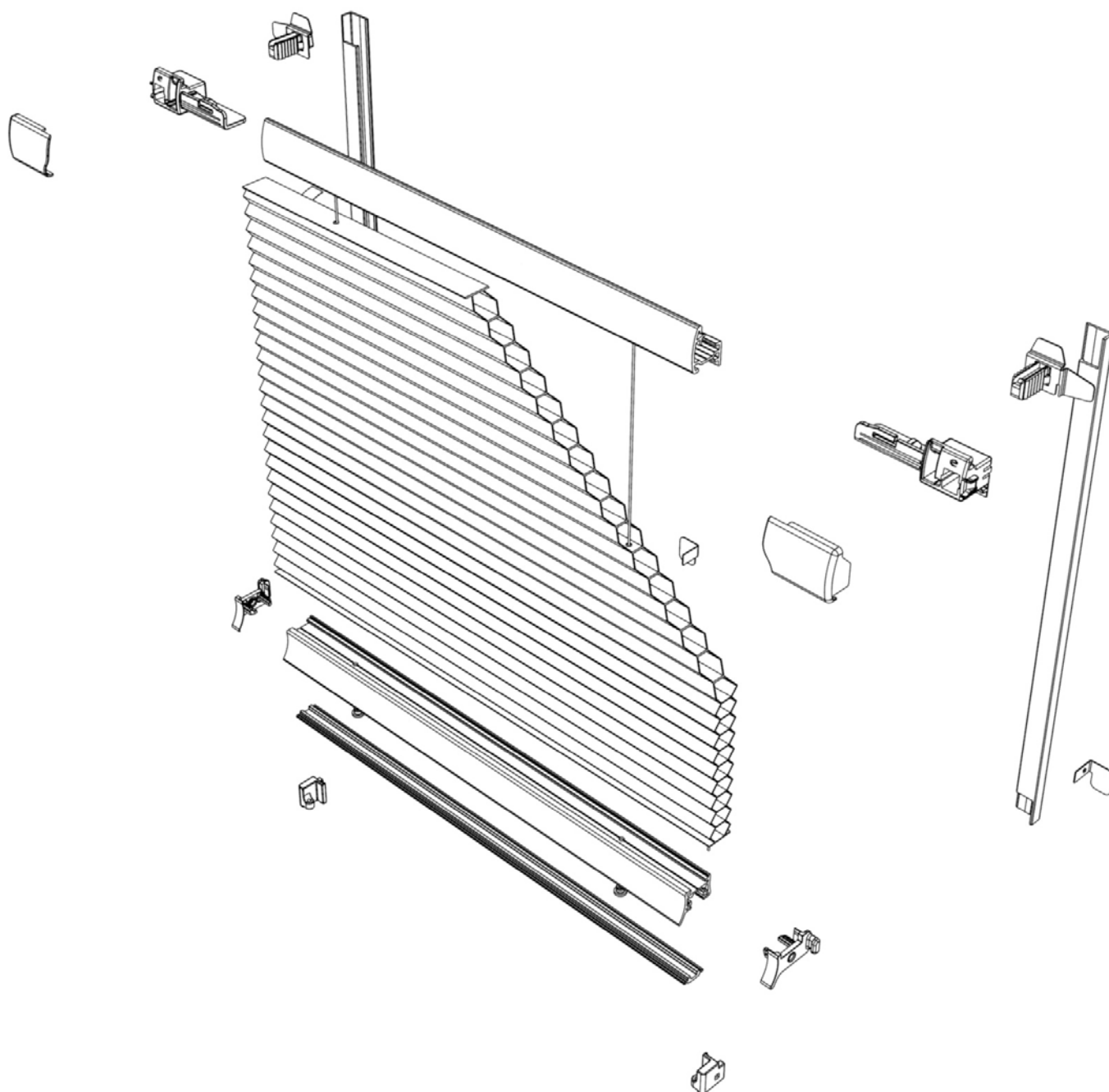



## Exploded Diagram: Screw Fit

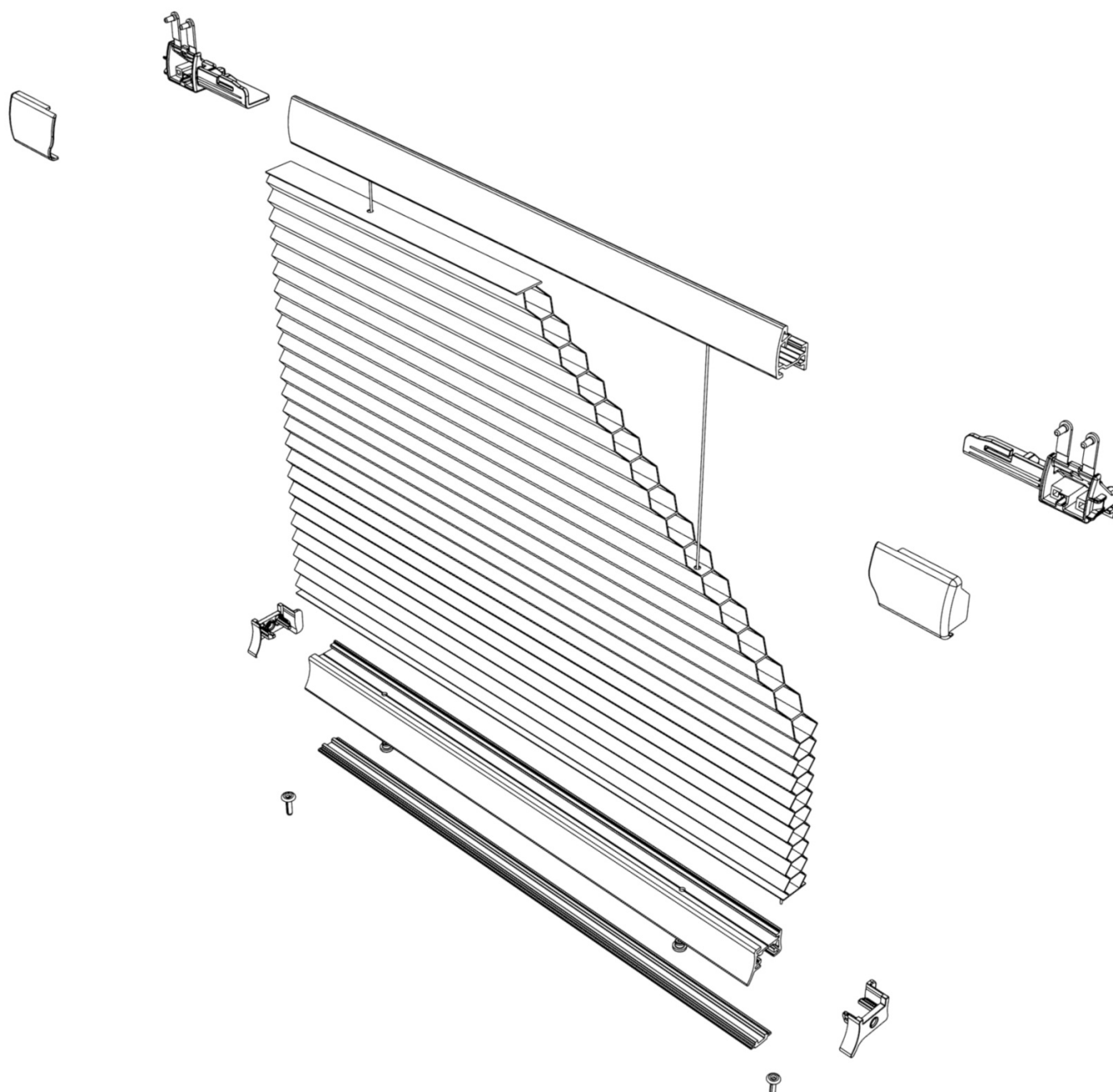

## Survey Instructions

### Measurements:

**Note:** Measure the glass size only.

- Measure the visible glass width at 3 different points as shown. Use the smallest measurement as the blind width.
- Measure the drop
- Check the rubber bead type
- Fill out the order form

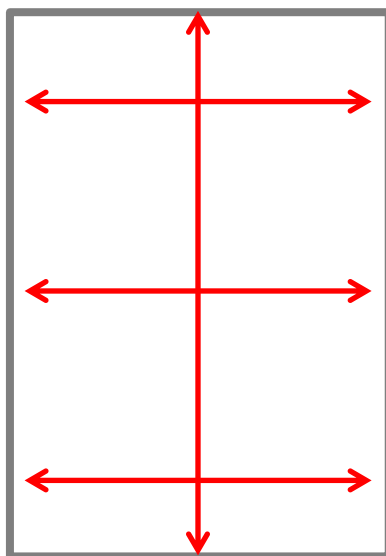

Tensioned Bead Fit/Guided Bead Fit			
Max Width	1000mm	Min Width	250mm
Max Drop	2000mm	Min Drop	250mm
Max Area	2m <sup>2</sup>	Min Bead Depth	N/A

Tensioned Screw Fit			
Max Width	1400mm	Min Width	250mm
Max Drop	2000mm	Min Drop	250mm
Max Area	2.5m <sup>2</sup>	Min Bead Depth	16mm

**Standard  
Rubber Bead**

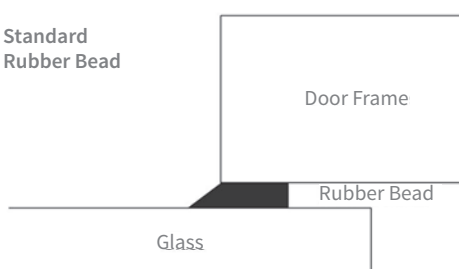

**Recessed  
Rubber Bead**

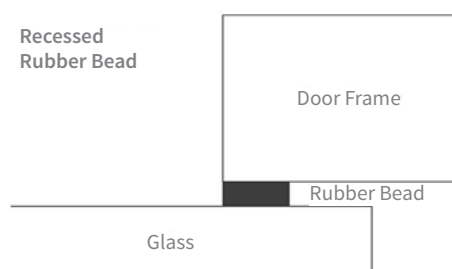

## INTU Micro Bead Fit

### You will need

- INTU Fitting Tool
- INTU Top corner brackets
- INTU Bottom corner brackets
- INTU Retention Clips

**Note:** The above should be supplied with your blind.

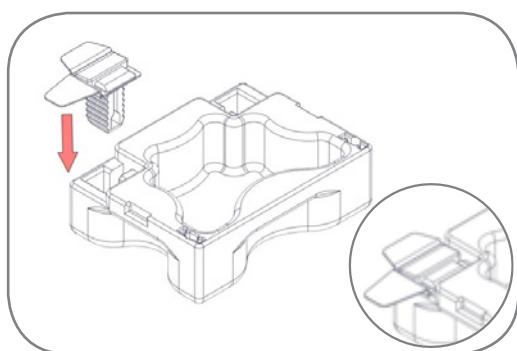

**1.** Place the top corner bracket into the slot on the fitting tool.

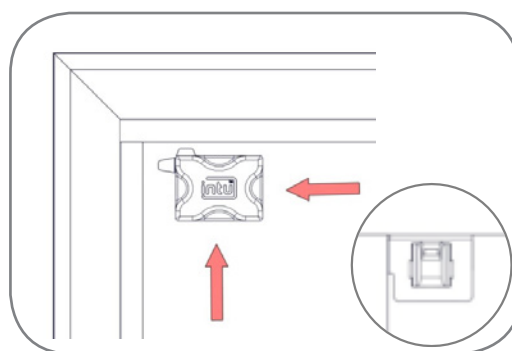

**2.** Position bracket behind the rubber bead and carefully push until the metal legs are behind the rubber bead. Check bracket is square to the sides of the bead and it is secure. Repeat for other side.

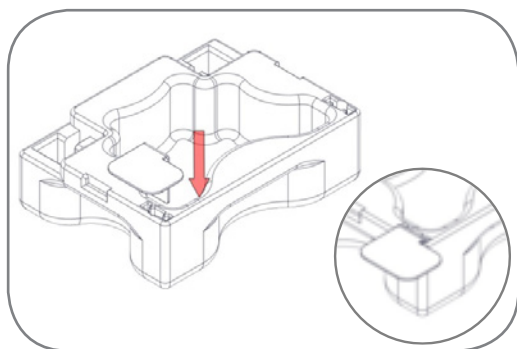

**3.** Place the bottom corner bracket into the slot on the fitting tool.

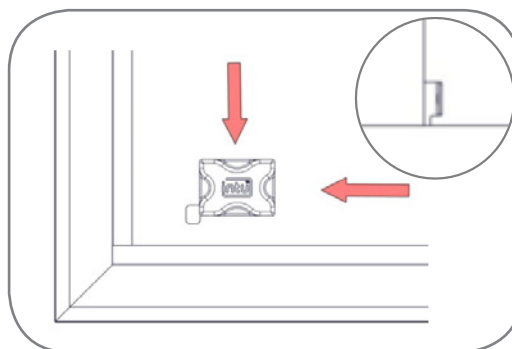

**4.** Position bracket behind the rubber bead and push until the metal leg is behind the bead. Check bracket is parallel to bead and is securely fitted. Repeat for the other side.

*continued...*

**(continued)**

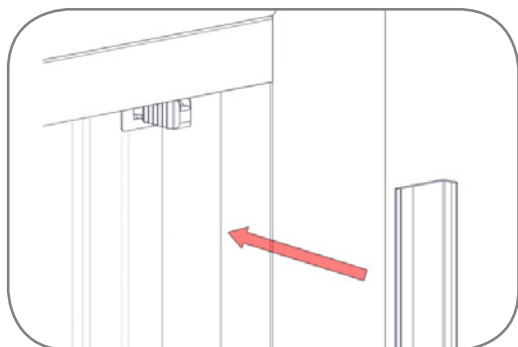

**5.** Place the flat side of the side extrusion against the glass with the notch to the bottom.

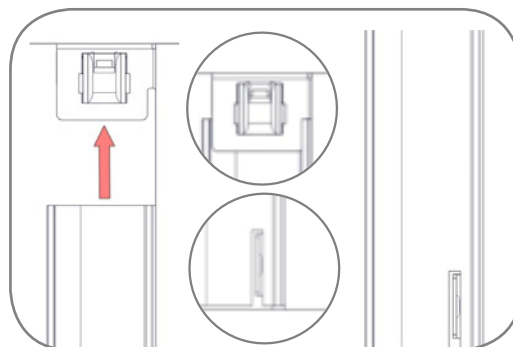

**6.** Slide the side extrusion up until its slots into the top corner fixing bracket. The side extrusion should rest under the bracket. Push the slot at the base of the extrusion over the bottom corner bracket. Repeat for both sides.

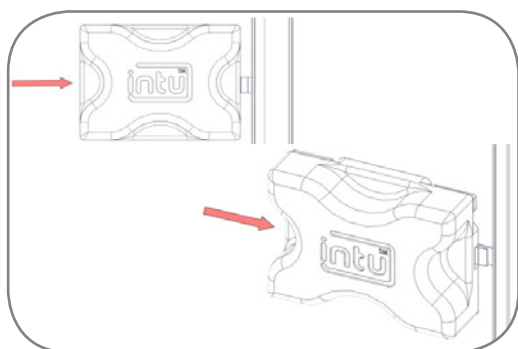

**7.** At the appropriate position(s) on each side profile, fit retention clips (long side profiles only). Press into position using the fitting tool.

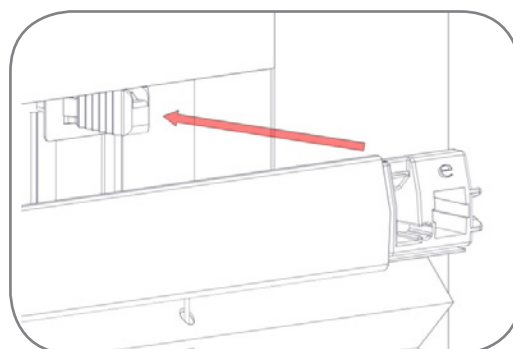

**8.** Align headrail endcaps with top corner fixing brackets and push fully home.

*continued...*

**(continued)**

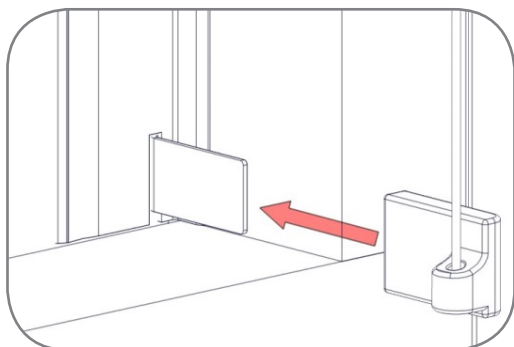

**9.** Align bottom button with bottom corner brackets. Slide the bottom button onto the bracket until it locates. Repeat both sides.

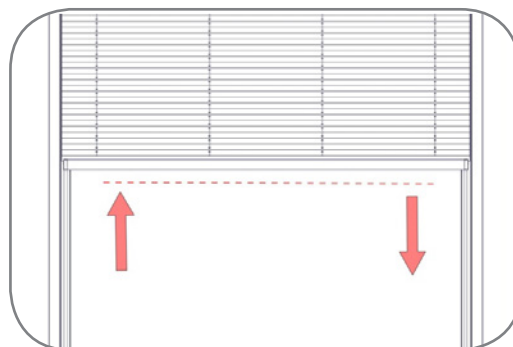

**10.** To align the bottom rail horizontally, simply pull it into the position desired. It will stay in position under tension from the cords.

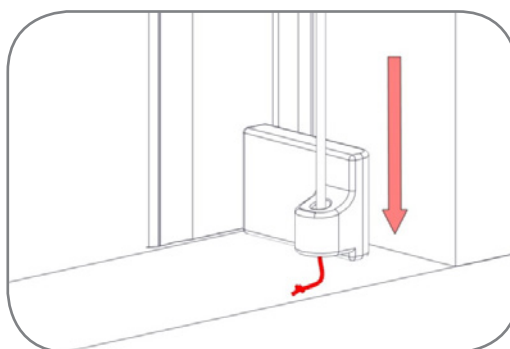

**11.** If your blind requires further tension pull the cord through the hole in bottom button until you feel the blind has sufficient tension and tie a fresh knot.

## INTU Micro Guided Bead Fit

### You will need

- INTU Fitting Tool
- INTU Top corner brackets
- INTU Bottom corner brackets

**Note:** The above should be supplied with your blind.

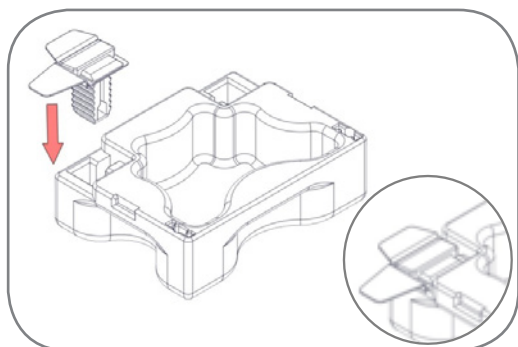

**1.** Place the top corner bracket into the slot on the fitting tool.

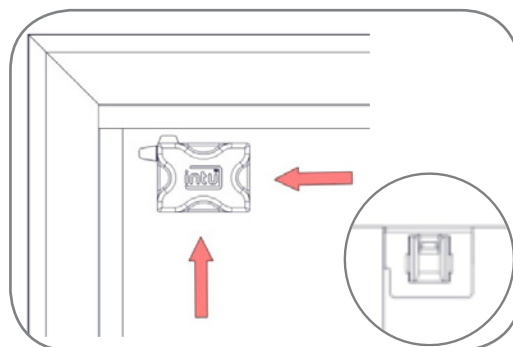

**2.** Position bracket behind the rubber bead and carefully push until the metal legs are behind the rubber bead. Check bracket is square to the sides of the bead and it is secure. Repeat for other side.

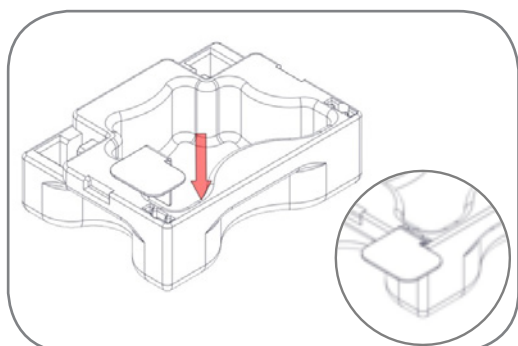

**3.** Place the bottom corner bracket into the slot on the fitting tool.

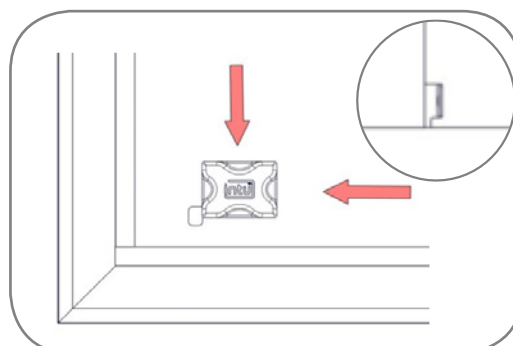

**4.** Position bracket behind the rubber bead and push until the metal leg is behind the bead. Check bracket is parallel to bead and is securely fitted. Repeat for the other side.

*continued...*

**(continued)**

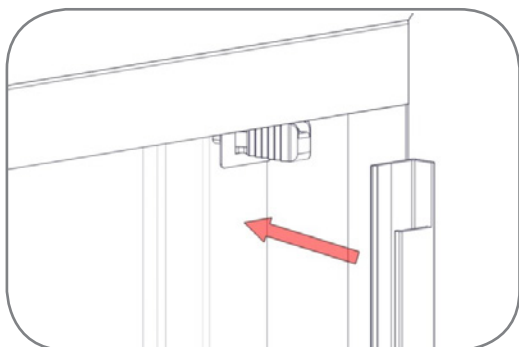

**5.** Ensure the glass is clean and free from debris by cleaning it with glass cleaner. Place the flat side of the side extrusion against the glass with the notch to the bottom.

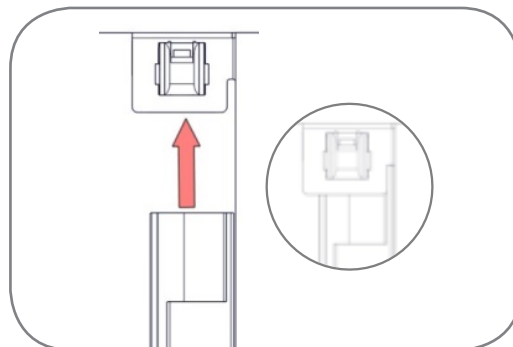

**6.** Slide the side extrusion up until its slots into the top corner fixing bracket. The side extrusion should rest under the bracket.

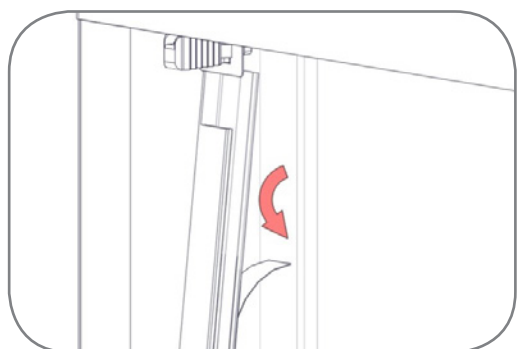

**7.** Pivot the extrusion towards yourself so you have access to the back. Peel the backing from the glass tape and slowly place the extrusion against the glass.

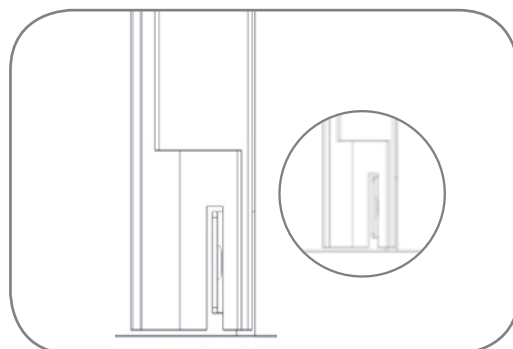

**8.** Push the slot at the base of the extrusion over the bottom corner bracket. Gently push the extrusion against the glass to ensure tape has adhered. Repeat for both sides.

*continued...*



**(continued)**

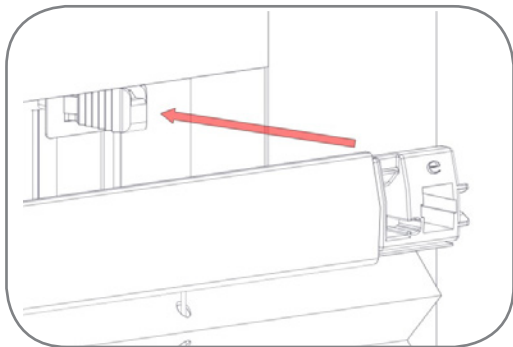

**9.** Align headrail endcaps with top corner fixing brackets and push fully home.

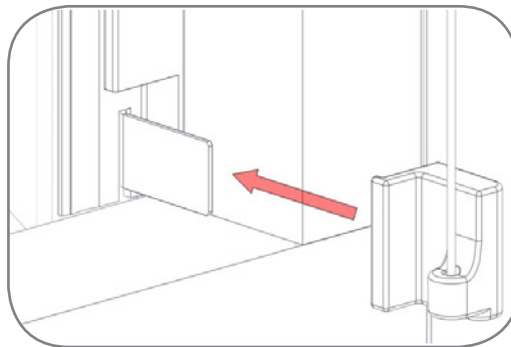

**10.** Align bottom button with bottom corner brackets. Slide the bottom button onto the bracket until it locates. Repeat both sides.

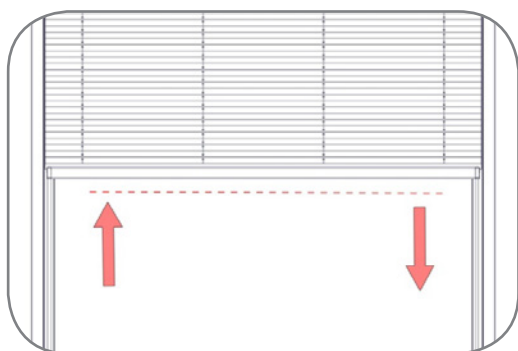

**11.** To align the bottom rail horizontally, simply pull it into the position desired. It will stay in position under tension from the cords.

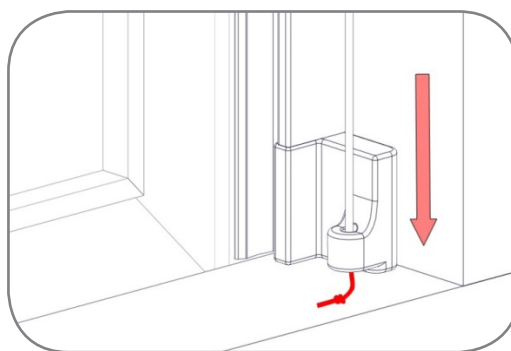

**12.** If your blind requires further tension pull the cord through the hole in bottom button until you feel the blind has sufficient tension and tie a fresh knot.

## INTU Micro Screw Fit

### You will need

- A drill
- Drill bits - Headrail: 2.5mm - Bottomrail: 3mm, 4mm and 4.5mm (depending on install, see page 7)
- 1x Phillips screwdriver
- 1x sharp knife or scissors
- 1x pen or pencil (optional)

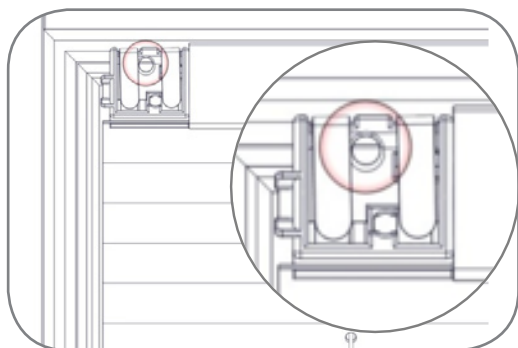

**1.** Place your blind against the frame of your door or window ensuring the back of the blind is parallel to the glass and the endcap sits comfortably on the bead. Place a small mark where the centre hole of the endcap is. Repeat this for both headrail endcaps.

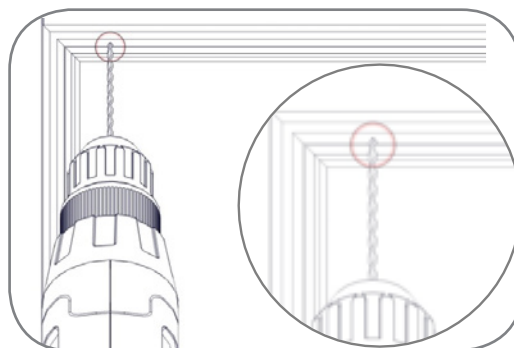

**2.** Using your mark as a guide. Drill into the bead at 45°. Repeat this process on the other side. (2.5mm drill bit).

**Note:** If installing into a square bead you will need to mark through the endcap and the right angle adaptor.

*continued...*

**(continued)**

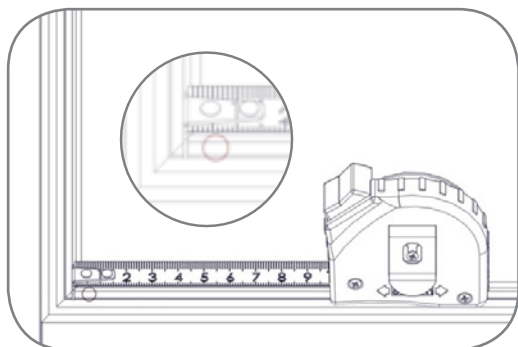

**3.** Mark 6mm from the bottom corner of the frame. Repeat this on the other side.

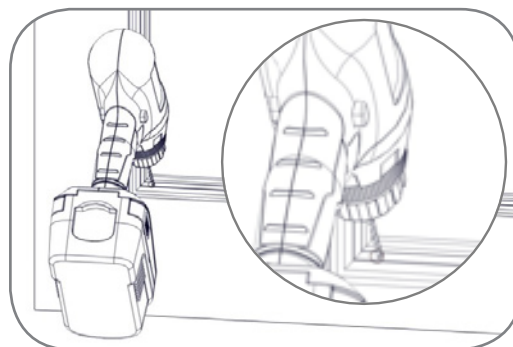

**4.** Drill as per table.

	ALUMINIUM/PVC	TIMBER
Blind Width < 590mm	2.5mm drill bit	4mm drill bit
Blind Width > 590mm	3mm drill bit	5.5mm drill bit

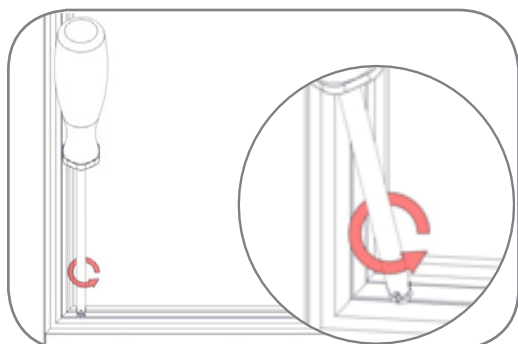

**For wooden beads only**

Using a No.1 Philips screwdriver, screw a brass bush into the pilot hole on the bottom bead. Repeat on the other side.

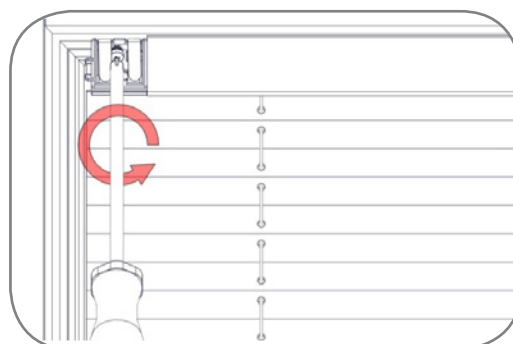

**5.** Line the blind up with the pilot holes in the top bead. Using the screws provided, screw the blind to the bead of the window/door.

*continued...*

**(continued)**

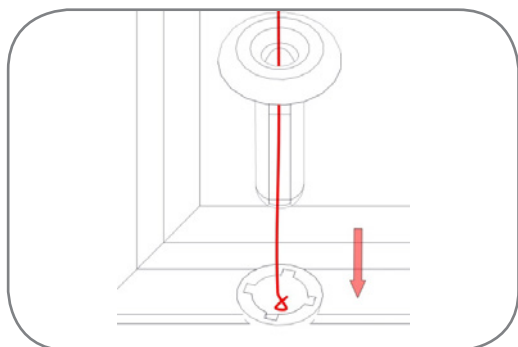

**6.** Insert the knot(s) on the loose cord into the pilot hole on the bottom bead followed by the bead grommet.

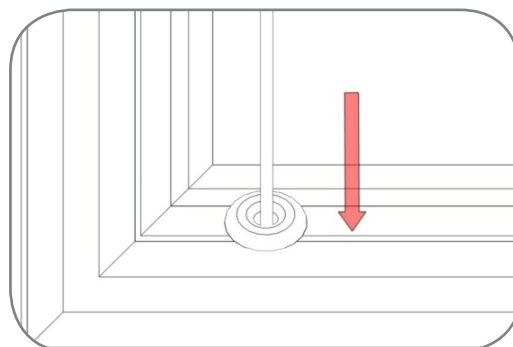

**7.** To secure the bead grommet ensure the cords are exiting the bead grommet towards you. Push the grommet until it is located fully. The cords should now be secured into the bead.

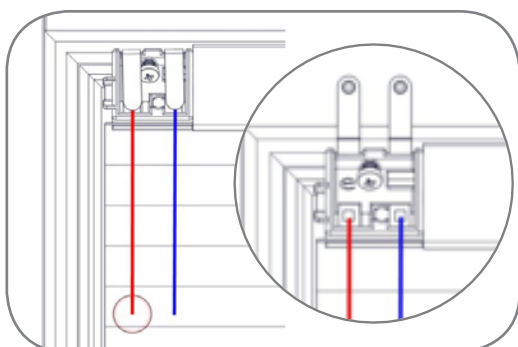

**8.** To tension blind, firmly hold the dangling cord from the headrail endcap and then open the gate. Repeat on the other side.

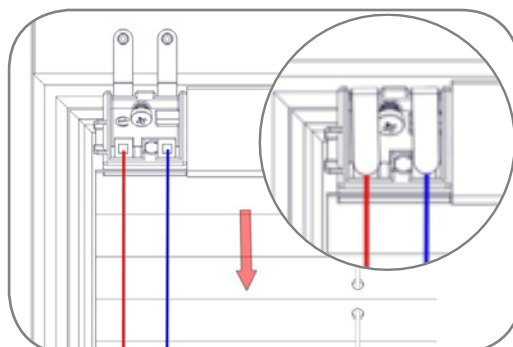

**9.** Slowly pull the cords until you feel resistance on both cords. Close the gate to secure the cord. Repeat this with all gates.

*continued...*

**(continued)**

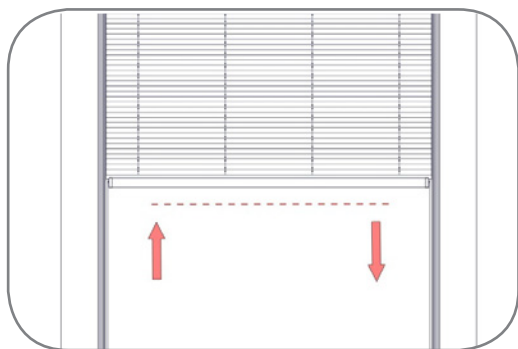

**10.** Test the tension by raising the blind, ensure it stays fully raised when released. Repeat the previous 2 steps if required. Ensure bottom bar is straight by adjusting it from side to side.

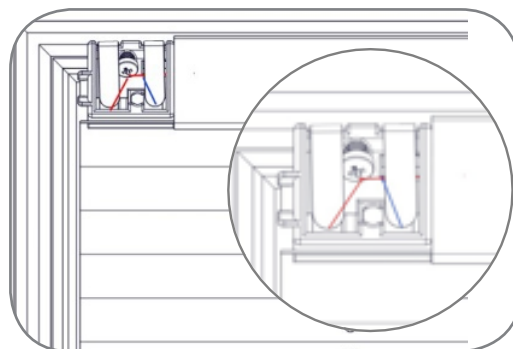

**11.** When satisfied with the tension, shorten the cords dangling out of the closed gate to 100mm and pass them through the gap on the side of the endcap to hide them. Repeat on other side.

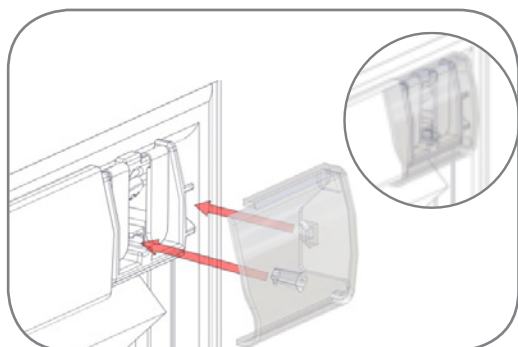

**12.** Attach endcap cover by aligning the clip on the side with the clip on the endcap. Push the endcap in fully until a click is heard.