

# S-Craft Wooden Blinds

CrosbyBlinds 2020

## GENOA COLLECTION SERINO RANGE TECHNICAL SPECIFICATIONS



March 2020 Version 1.1



## THE MADE-TO-MEASURE GENOA COLLECTION FROM S:CRAFT

The Genoa collection is the most comprehensive blind range in the UK offering a multitude of configurations and finishing options. S:CRAFT Serino range of blinds are of exceptional build quality and give a superior solution for any type of window.

### Features Include:

#### ● Complete Privacy

Total privacy and minimal light leakage when closed

- Tightest slat closure on the market for increased black-out
- Patented privacy slast -reducing light bleed
- No large punched holes in slats for minimal light leakage

#### ● Industry Leading Functionality

- Advanced easy-lock mechanism
- A single headrail can be used with a number of blinds allowing for all cords to be consolidated at either end of the blind
- Ability to cut-out the blind around door or window furniture
- Hold down brackets for face fixing to doors
- Trapezoid bottom rail eliminates rocking and damage to window sill
- Slats are made of a lightweight hardwood with a beautiful grain
- Easy to use, clean and maintain.

#### ● Exceptional Options

- 50mm and 63mm shutter style slat
- 10 paint, 17 stain colours and 10 Osmo finish options
- 16 plain cloth tapes
- Polydeco headrail with a choice of 16 headrails colours
- High quality, matching wooden valence with a choice of 9 different styles
- Choice of 4 toggle designs

#### ● Superior Quality

- Comes with child safety cord consolidator as standard reducing the risk of potential strangulation
- +/- 6mm tolerance on drop
- Window spans of up to 3 meters on a single blind can be covered in a paint finish
- Tapes, strings and cords consistently placed same distance from end of slat
- Finished with 10 Coats plus UV protection layer to resist fading

\* Only available on New Privacy Slat not Centre Slat

## 2. COMPONENTS AND ACCESSORIES

[BACK TO MENU](#)

SPEC04-2019

### SMART PRIVACY WITH LADDER CORD

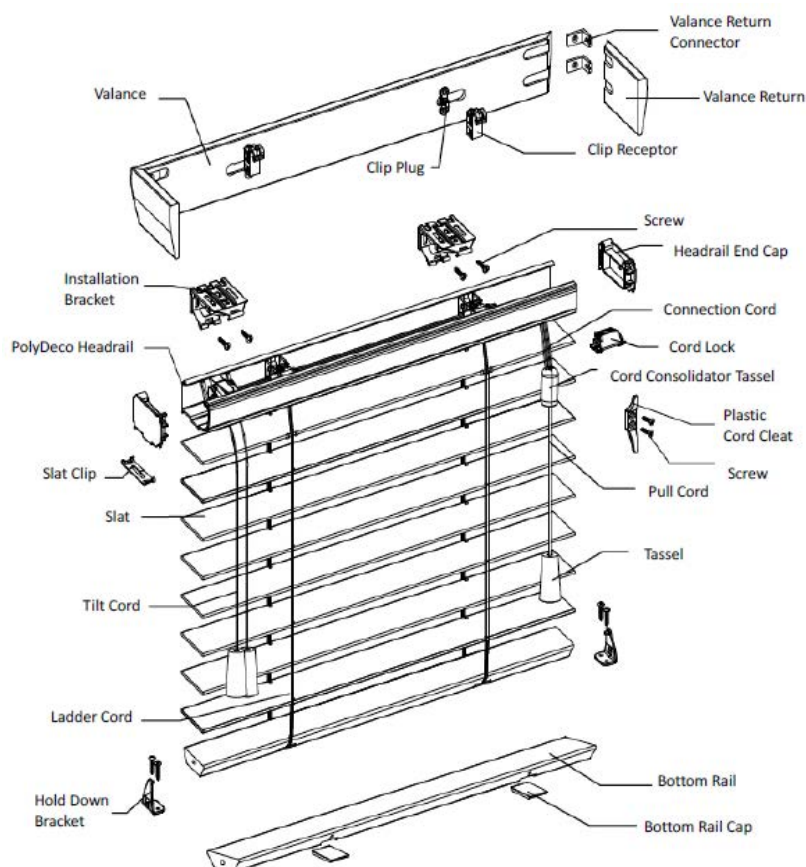

### CENTRE SLOT WITH CLOTH TAPE

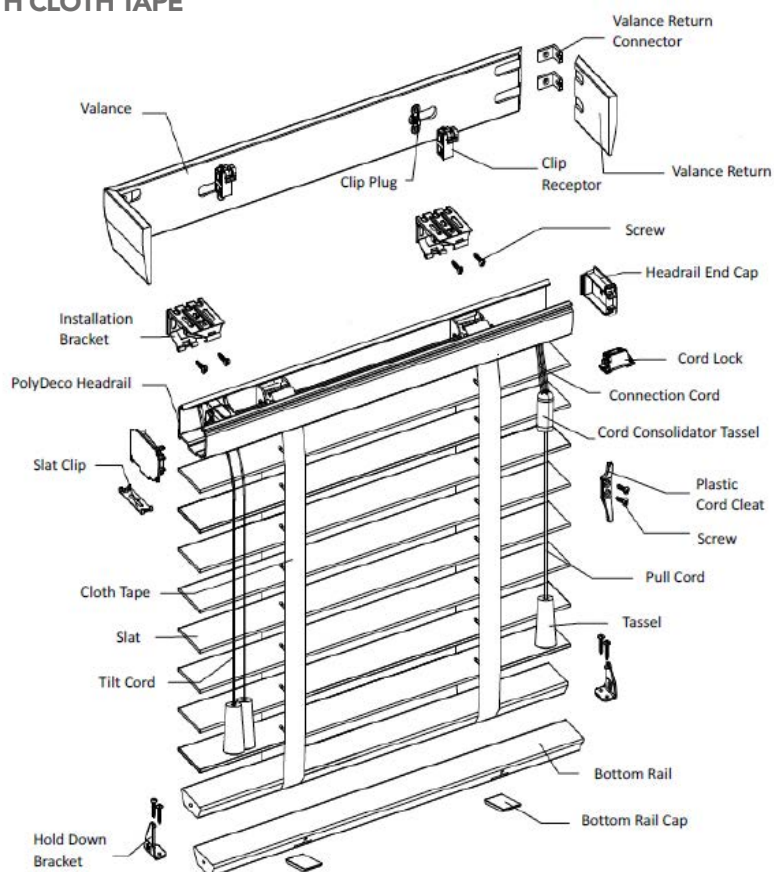

©S:CRAFT Copyright in this material belongs to S:CRAFT and copying or reproduction in whole or in part is strictly prohibited. We reserve the right to alter specifications without prior notice.

## BOTTOM RAIL

[BACK TO MENU](#)

Incorporate a flush bottom rail cap to minimize gap at the bottom of the blind for recess mount and dent free for window casement.

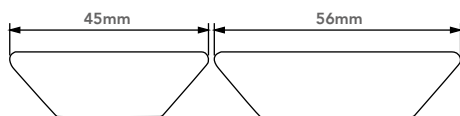

## BOTTOM RAIL CAP

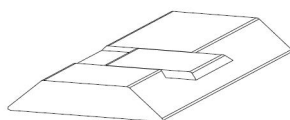

## SLAT SIZES

50.8mm & 63.5mm

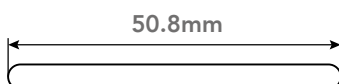

## SMART PRIVACY

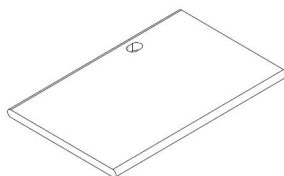

For ladder cord  
(default)

## CENTRE SLOT

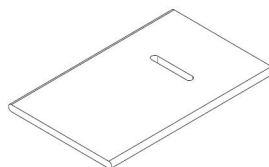

For cloth tape only

**NB.** For privacy blinds, the alignment of the slats cannot be guaranteed in the specs under general specification/ mounting type and size definition.

## HOLD DOWN BRACKET

[BACK TO MENU](#)

Supplied with each blind.



For 50.8mm slat

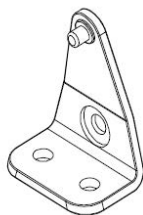

For 63.5mm slat

## CORD CLEAT

Two supplied with each blind.



## SPACER BLOCK

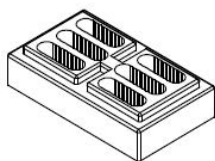

NB. First spacer block will extend the bracket out by 10mm, two spacer blocks will extend by 18mm.

Default to provide for 63mm blinds outside mount with aluminium headrail only.

## VALANCE INSTALLATION PARTS

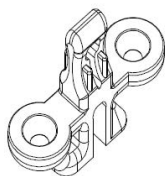

Valance Clip (plug)

Used for 114.3mm Crown Valance and 114.3mm Modern Valance

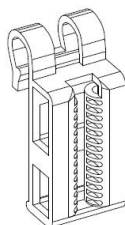

Valance Clip (receptor)

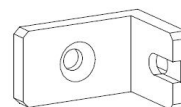

L shape Valance Return Connector

#### MOUNTING TYPE AND SIZE DEFINITION

	Inside Mount (IM)	Outside Mount (OM)
Mounting Position	Blind fits within window opening	Blind overlaps window opening
Order Size	<b>Window opening size:</b> Provide the smallest measurement from the top, middle and bottom measurement. Top measurement is critical because the headrail must fit. Measure the height left, center and right and provide the biggest height.	<b>Net size:</b> Measure the desired width and height. To minimize light leakage, the blind should overlap the window opening at least 50mm on each side and at the bottom.
Finished Blind Size	Width = Order width - 9.5mm Drop = Order Height	Width = Order Width Drop = Order Height

Finished blind width is equal to slat length; finished blind drop is measured from top edge of headrail to bottom edge of bottom rail with slats in closed position when blind is fully released.

Tolerance on width:  $\pm 2\text{mm}$ ;  
 Tolerance on drop: 0~10mm.

#### NOTICE FOR CORDED VENETIANS (SMART PRIVACY)

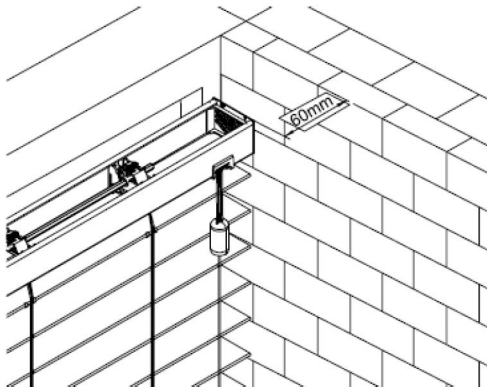

To ensure the operation at cord lock side, if the blind is installed close to the wall, please specify on the order form, and also inform on the order the distance from the cord lock side to the wall when it is less than 60mm.

#### SIZE LIMIT

Blind Type		Width				Height		
		Minimum (no cord lock)	Minimum (with cord lock)		Maximum		Minimum	Maximum
			RL/LR	RR/LL	Paint	Stain		
Single Blind		165mm	305mm	459mm	2743mm	2438mm	254mm	3048mm
Multiple Blinds on one headrail	2-on-1	N/A	616mm	924mm	2743mm			
	3-on-1	N/A	927mm	1389mm				

## 50.8MM AND 63.5MM SIZING CHART

[BACK TO MENU](#)

The maximum area for a Serino single blind (or each section of 2-on-1 or 3-on-1 blind): 7.43m<sup>2</sup>, refer to the following chart for easier calculation.

Width (mm)	2467	2500	2600	2700	2800	2900	3048
Max Drop (mm)	3012	2972	2858	2752	2654	2562	2438

## BRACKET SCHEDULE

Blind width	Installation bracket qty	Supporting bracket qty	Swivel bracket qty	Stainless steel L bracket qty
$X \leq 940\text{mm}$	2	N/A	2	2
$940\text{mm} < X \leq 1194\text{mm}$	2	1	3	3
$1194\text{mm} < X \leq 1524\text{mm}$	2	2	4	4
$1524\text{mm} < X \leq 1905\text{mm}$	2	2	4	4
$1905\text{mm} < X \leq 2438\text{mm}$	2	3	5	5
$2438\text{mm} < X \leq 3048\text{mm}$	2	3	5	5

## VALANCE AND RETURN SIZE

- No valance return for inside mount - supplied valance will be butt cut.
- Short returns supplied, if returns are required during an inside mount.
- Outside mount blind comes with valance returns, if requested.
- Outside mount valance return length: for 50.8mm & 63.5mm blind, will depend on the installation bracket type, for 50.8mm bracket is 76mm and for 63.5mm bracket is 87mm.

### IM without valance return

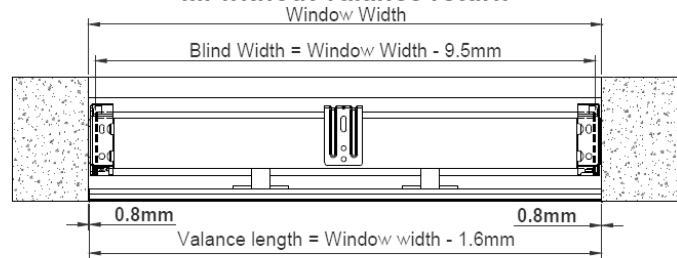

### IM with valance return

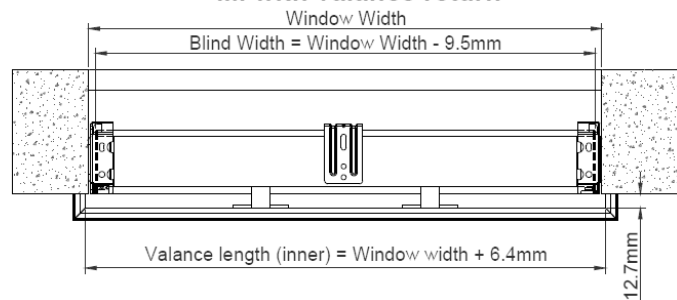

### OM with valance return

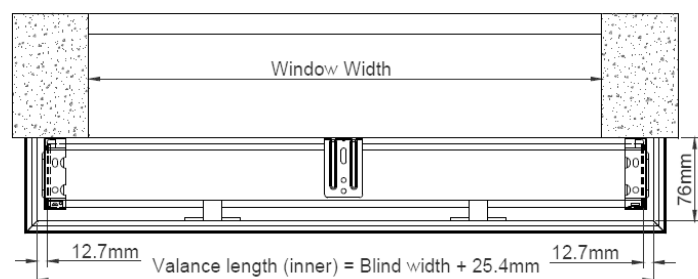

Default	Optional
Cord tilt left (L), pull cord right (R)	Cord tilt right (R), pull cord left (L)
	Cord tilt right (R), pull cord right (R)
	Cord tilt left (L), pull cord left (L)
	Centre tilt only for a small blind with a width between 165 - 305 mm

Tilter will be at the outer end when both controls are at the same side. Blinds with width between 305mm and 458mm must have split control, one on left and one on right.

**When the width is between 165 and 305 there will be no lift mechanism. There will only be a tilt mechanism at the centre of the headrail.**

### LADDER CORD SCHEDULE

Blind Width	50mm Slat				Blind Width	63mm Slat			
	Smart Privacy		Centre Slot			Smart Privacy		Centre Slot	
	Ladder	Cord	Ladder	Cord		Ladder	Cord	Ladder	Cord
$165\text{mm} \leq W \leq 305\text{mm}$	2	4	2	2	$165\text{mm} \leq W \leq 305\text{mm}$	2	2	2	2
$305\text{mm} \leq W \leq 813\text{mm}$	2	4	2	2	$305\text{mm} \leq W \leq 927\text{mm}$	2	4	2	2
$813\text{mm} < W \leq 1372\text{mm}$	3	5	3	2	$927\text{mm} \leq W \leq 1372\text{mm}$	3	5	3	3
$1372\text{mm} < W \leq 1981\text{mm}$	4	4	4	4	$1372\text{mm} \leq W \leq 1905\text{mm}$	4	4	4	4
$1981\text{mm} < W \leq 2438\text{mm}$	5	5	5	3	$1905\text{mm} \leq W \leq 2438\text{mm}$	5	5	5	5
$2438\text{mm} < W \leq 2743\text{mm}$	6	6	6	4	$2438 \leq W \leq 2743\text{mm}$	6	6	6	6

NB. When the width is  $165\text{mm} \leq W \leq 305\text{mm}$ , there is no cord lock (lift), just a tilt, and the tilt is centre of the headrail.

### CORD LENGTH

No.	Installation Height	Blind Height	Cord Length below the Tassel
1	Unknown	$762\text{mm} \geq Y \geq 254\text{mm}$	508mm
2		$1499\text{mm} \geq Y > 762\text{mm}$	2/3Y
3		$2502\text{mm} \geq Y > 1499\text{mm}$	1000mm
4		$3048\text{mm} \geq Y > 2502\text{mm}$	Y - 1500mm
5	Known	$2008\text{mm} \geq \text{Installation Height}$	508mm
6		$3048\text{mm} \geq Y \geq 254\text{mm}$ Note: Installation Height > 2008mm	Installation Height-1500mm
7	-	Order Height	Custom Length

Installation Height: From floor to the top edge of blinds

NB. The cord length is for your information and may not be the exact length.

## MULTIPLE BLINDS ON ONE HEADRAIL (SURCHARGE)

[BACK TO MENU](#)

2 on 1 headrail

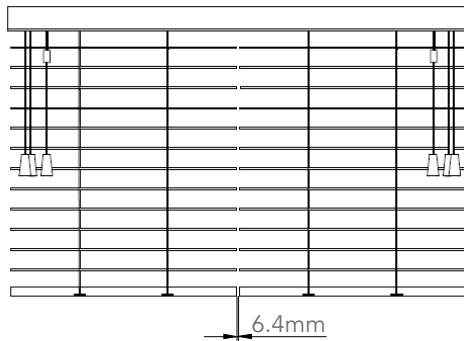

3 on 1 headrail

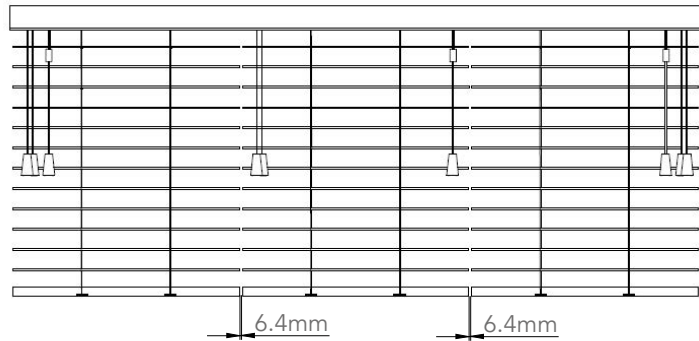

- Alignment of slats is not guaranteed for multiple blinds on one headrail.

## COMMON VALANCE

- If you require one valance to cover side by side blinds, please use special instructions on the order card to advise us of valance length required.
- Common valance is used for side by side blinds sharing one valance.
- Alignment of slats is not guaranteed for the side by side blinds.
- Valance will be spliced if length exceeds 3100mm in paint and 2500mm in stain. We will supply valance connector for joining.
- Minimum gap size between two blinds is 8mm

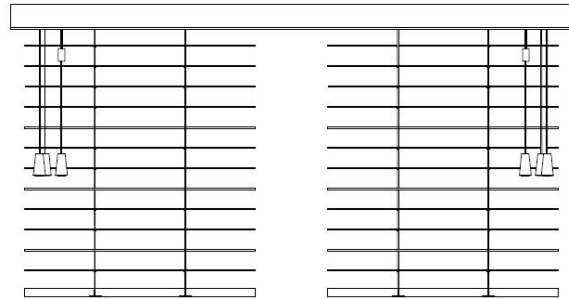

NB. For Smart Privacy blinds, the alignment of the slats cannot be guaranteed in the specs under 'General Specifications' Mounting Type and Size Definition..

## GROOVE FOR VALANCE

- For the common valance or custom valance size, the valance will be made with groove as per the adjacent drawing.
- If the common valance or custom valance size exceeds the limit and needs to be split, the valance will be made with groove as per the adjacent drawing.

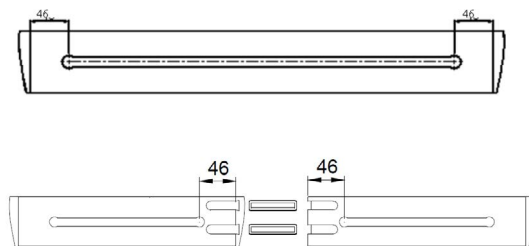

## CUT-OUTS (SURCHARGE)

A cut-out is a blind with an area removed from it to avoid an existing obstruction.

Please provide detailed measurement of the area to be removed. Mark your measurements on a template of the cut-out to ensure a perfect fit to your window.

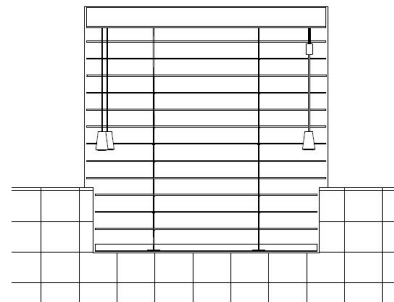

37 Colours in total: 10 paint, 17 stain (1 chargeable colour - Matte Black) and 10 Osmo finish

### 10 paint colours

All paint colours have the grain infilled to give a smooth clean finish

Blind Colour		Polydeco Headrail	Headrail End Cap	Bracket	Ladder/Pull Cord	Safety Tassel
001 Pure White		2080 Pure White	2037 Snow White	3058 White	T001 White	2037 Snow White
003 Silk White		2003 Silk White	2037 Snow White	3058 White	T001 White	2037 Snow White
006 Pearl		2095 Pearl	2012 Cameo	H002 Vanilla	5020 Alabaster	2012 Cameo
012 Crisp Linen		20102 Crisp Linen	2012 Cameo	H002 Vanilla	5020 Alabaster	2012 Cameo
019 String		20102 Crisp Linen	2012 Cameo	H002 Vanilla	5020 Alabaster	2012 Cameo
032 Sea Mist		2150 Sea Mist	2150 Sea Mist	3150 Sea Mist	5107 Silver	2139 Silver Grey
080 Taupe Grey		2151 Taupe Grey	2151 Taupe Grey	3132 Light Grey	5107 Silver	2151 Taupe Grey
049 Stone Grey		2138 Grey	2138 Grey	3132 Light Grey	T168 Grey	P101 Grey
053 Clay		2148 Clay	2148 Clay	3115 Bright Steel	T201 Black	P201 Black
051 Brown Grey		2141 Granite	2141 Granite	3105 Grey	T168 Grey	P101 Grey

### 10 Osmo finish options

















What is OSMO? The OSMO color is made from natural plant oil and vegetable wax, so it's free of harmful substances. It's a very safe paint. Since OSMO color is permeable paint, which can prevent the degradation of the slats and present the exquisite grain of Normandy blind. It's a good-looking and health-friendly color series. All of the OSMO colors are special stains that enhance the wood grain and therefore the final product may appear different than the samples due to natural variations found in wood.

Blind Colour		Polydeco Headrail	Headrail End Cap	Bracket	Ladder/Pull Cord	Safety Tassel
1003 White Matte		2059 Limed White	2059 Limed White	3059 Limed White	5020 Alabaster	2012 Cameo
1501 Oak		2592 Natural Oak	2572 Natural Oak	3523 Sugar Maple	5526 Cottage Pine	P501 Wheat
1107 Oak Antique		2483 Dark Teak	2466 Bronze Brown	3413 Walnut	5413 Walnut	2413 Walnut
1502 Teak		2485 French Oak	2472 French Oak	3523 Sugar Maple	5526 Cottage Pine	P501 Wheat
1301 Cherry		2537 Oak Mantel	2522 Teak	3523 Sugar Maple	5526 Cottage Pine	2522 Teak
1401 Mahogany		2483 Dark Teak	2466 Bronze Brown	3413 Walnut	5413 Walnut	2413 Walnut
1109 Silk Grey		2138 Grey	2138 Grey	3132 Light Grey	T168 Grey	P101 Grey
1111 Granite Grey		2152 Granite Grey	2152 Granite Grey	3152 Granite Grey	T168 Grey	P101 Grey
1203 Black		2202 Black Walnut	2202 Black Walnut	3436 Coffee	T201 Black	P201 Black
1204 Ebony		2202 Black Walnut	2202 Black Walnut	3436 Coffee	T201 Black	P201 Black

©S:CRAFT Copyright in this material belongs to S:CRAFT and copying or reproduction in whole or in part is strictly prohibited.  
We reserve the right to alter specifications without prior notice.

**17 Stained colours**

All stained colours do not have the grain infilled to showcase the woods natural beauty

Blind Colour		Polydeco Headrail	Headrail End Cap	Bracket	Ladder/Pull Cord	Safety Tassel
108 Rustic Grey		2134 Driftwood	2124 Driftwood	3105 Grey	T168 Grey	P101 Grey
109 Weathered Teak		2202 Black Walnut	2202 Black Walnut	3436 Coffee	T168 Grey	P101 Grey
110 Limed White		2059 Limed White	2059 Limed White	3059 Limed White	5020 Alabaster	2012 Cameo
114 Taupe		2484 Taupe	2484 Taupe	3484 Taupe	5020 Alabaster	P501 Wheat
204 Oak Mantel		2537 Oak Mantel	2522 Teak	3523 Sugar Maple	5526 Cottage Pine	2522 Teak
211 Cherry		2457 Old Teak	2435 Old Teak	3436 Coffee	5413 Walnut	P401 Cherry
212 Dark Teak		2483 Dark Teak	2466 Bronze Brown	3413 Walnut	5413 Walnut	2413 Walnut
215 Cordovan		2457 Old Teak	2435 Old Teak	2457 Old Teak	2435 Old Teak	3436 Coffee
219 Mahogany		2459 Dark Mahogany	2479 Dark Mahogany	5430 Mahogany	2437 Mahogany	2413 Walnut
220 New Ebony		2202 Black Walnut	2202 Black Walnut	3436 Coffee	T168 Grey	P101 Grey
221 Black Walnut		2202 Black Walnut	2202 Black Walnut	3208 Black	T201 Black	P201 Black
227 Red Oak		2537 Oak Mantel	2522 Teak	3523 Sugar Maple	5526 Cottage Pine	2522 Teak
230 Old Teak		2457 Old Teak	2435 Old Teak	3436 Coffee	5413 Walnut	2413 Walnut
233 Dark Mahogany		2459 Dark Mahogany	2479 Dark Mahogany	3436 Coffee	5430 Mahogany	2437 Mahogany
237 Wenge		2437 Mahogany	2437 Mahogany	3436 Coffee	5430 Mahogany	2437 Mahogany
246 Matte Black		2219 Matte Black	P201 Black	3208 Black	T201 Black	P201 Black
862 French Oak		2592 Natural Oak	2572 Natural Oak	3523 Sugar Maple	5526 Cottage Pine	P501 Wheat

## SERINO CLOTH TAPE COLOURS

[BACK TO MENU](#)

Face width 25.4mm. Available only with notch out slat



## 4. STACKING HEIGHTS

[BACK TO MENU](#)

CUSTOM BLINDS STACK SIZE (MM)						
Blinds Height	50.8mm Slat			63.5mm Slat		
mm	LC	CT	DT	LC	CT	DT
250	99	100.4	102.3	108	109	110.4
300	103	105	107.4	111.9	113.3	115.1
350	107	109.5	112.5	115.9	117.7	119.9
400	110	114	117.6	119.9	122	124.6
450	114	118.6	122.7	123.8	126.3	129.4
500	118	123.1	127.8	127.8	130.6	134.1
550	122	127.7	133	131.8	134.9	138.8
600	126	132.2	138.1	135.7	139.2	143.6
650	130	136.8	143.2	139.7	143.5	148.3
700	134	141.3	148.3	143.7	147.8	153.1
750	138	145.9	153.4	147.6	152.1	157.8
800	142	150.4	158.5	151.6	156.4	162.5
850	146	155	163.6	155.6	160.8	167.3
900	150	159.5	168.8	159.5	165.1	172
950	154	164	173.9	163.5	169.4	176.8
1000	158	168.6	179	167.5	173.7	181.5
1050	162	173.1	184.1	171.5	178	186.3
1100	166	177.7	189.2	175.4	182.3	191
1150	170	182.2	194.3	179.4	186.6	195.7
1200	174	186.8	199.4	183.4	190.9	200.5
1250	178	191.3	204.5	187.3	195.2	205.2
1300	182	195.9	209.7	191.3	199.6	210
1350	186	200.4	214.8	195.3	203.9	214.7
1400	190	205	219.9	199.2	208.2	219.4
1450	194	209.5	225	203.2	212.5	224.2
1500	198	214	230.1	207.2	216.8	228.9
1550	202	218.6	235.2	211.1	221.1	233.7
1600	206	223.1	240.3	215.1	225.4	238.4
1650	210	227.7	245.5	219.1	229.7	243.1
1700	214	232.2	250.6	223	234	247.9
1750	218	236.8	255.7	227	238.3	252.6
1800	222	241.3	260.8	231	242.7	257.4
1850	226	245.9	265.9	234.9	247	262.1
1900	230	250.4	271	238.9	251.3	266.9
1950	234	255	276.1	242.9	255.6	271.6
2000	238	259.5	281.3	246.8	259.9	276.3
2050	242	264	286.4	250.8	264.2	281.1
2100	246	268.6	291.5	254.8	268.5	285.8
2150	250	273.1	296.6	258.8	272.8	290.6
2200	254	277.7	301.7	262.7	277.1	295.3

## CrosbyBlinds 2020

CUSTOM BLINDS STACK SIZE (MM)						
Blinds Height	50.8mm Slat			63.5mm Slat		
mm	LC	CT	DT	LC	CT	DT
2250	258	282.2	306.8	266.7	281.4	300
2300	262	286.8	311.9	270.7	285.8	304.8
2350	266	291.3	317	274.6	290.1	309.5
2400	270	295.9	322.2	278.6	294.4	314.3
2450	274	300.4	327.3	282.6	298.7	319
2500	278	305	332.4	286.5	303	323.8
2550	282	309.5	337.5	290.5	307.3	328.5
2600	285	314	342.6	294.5	311.6	333.2
2650	289	318.6	347.7	298.4	315.9	338
2700	293	323.1	352.8	302.4	320.2	342.7
2750	297	327.7	358	306.4	324.6	347.5
2800	301	332.2	363.1	310.3	328.9	352.2
2850	305	336.8	368.2	314.3	333.2	356.9
2900	309	341.3	373.3	318.3	337.5	361.7
2950	313	345.9	378.4	322.2	341.8	366.4
3000	317	350.4	383.5	326.2	346.1	371.2
3050	321	355	388.6	330.2	350.4	375.9

### WARRANTY

S:CRAFT blinds are backed by a warranty up to 2 years, starting from the shipping date of the order.

Covered	Not Covered
<ul style="list-style-type: none"> <li>All internal hardware including components and brackets are covered</li> <li>Operational cords</li> <li>Colour fastness</li> <li>Material and workmanship</li> </ul>	<ul style="list-style-type: none"> <li>Any damage caused by unauthorised repairs, modified or improper installation, cleaning or maintenance</li> <li>Accidents, alterations, misuse, abuse to the product</li> <li>Exposure to elements (sun, wind, water/moisture, and fading or discolouration over time</li> <li>Shipping charges, any removal and reinstallation related cost</li> <li>Any conditions caused by normal wear and tear</li> </ul>

## CrosbyBlinds 2020